

Push Button & Rotary Switch Covers S2153

- Captured by the rotary or pushbutton switch bezel
- Fits both 30.5mm and 22.5mm diameter switches
- Clear base and cover allow visibility of nameplates and labels
- Accommodates buttons up to 40mm diameter and 45mm tall

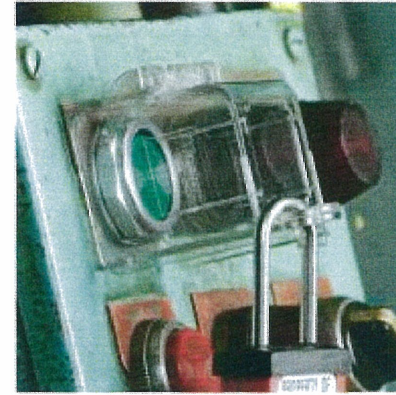

S2153 Installed Push Button
and Rotary Switch Cover



Push Button & Rotary Switch Covers S2151

- Designed to increase the safety of power isolation
- Used to lock out push buttons and rotary switches from 22.5 mm to 30.5 mm in diameter
- Accommodates buttons up to 50mm diameter and 45mm tall
- Clear base and cover allow visibility of nameplates and labels
- Strong transparent ABS body
- Self-adhesive fastening system
- S2152AST Pack of 12 new install bases allows one S2151 to service multiple switches on same panel

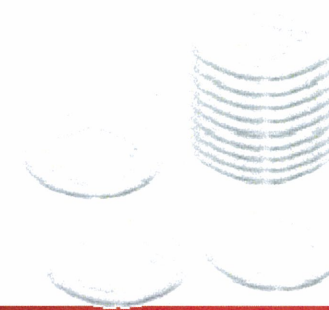
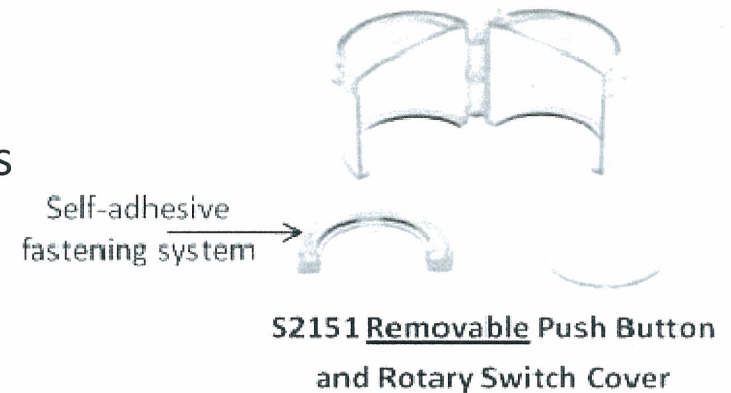

Push Button & Rotary Switch Covers S2151 – S2153

Instructions to apply S2151

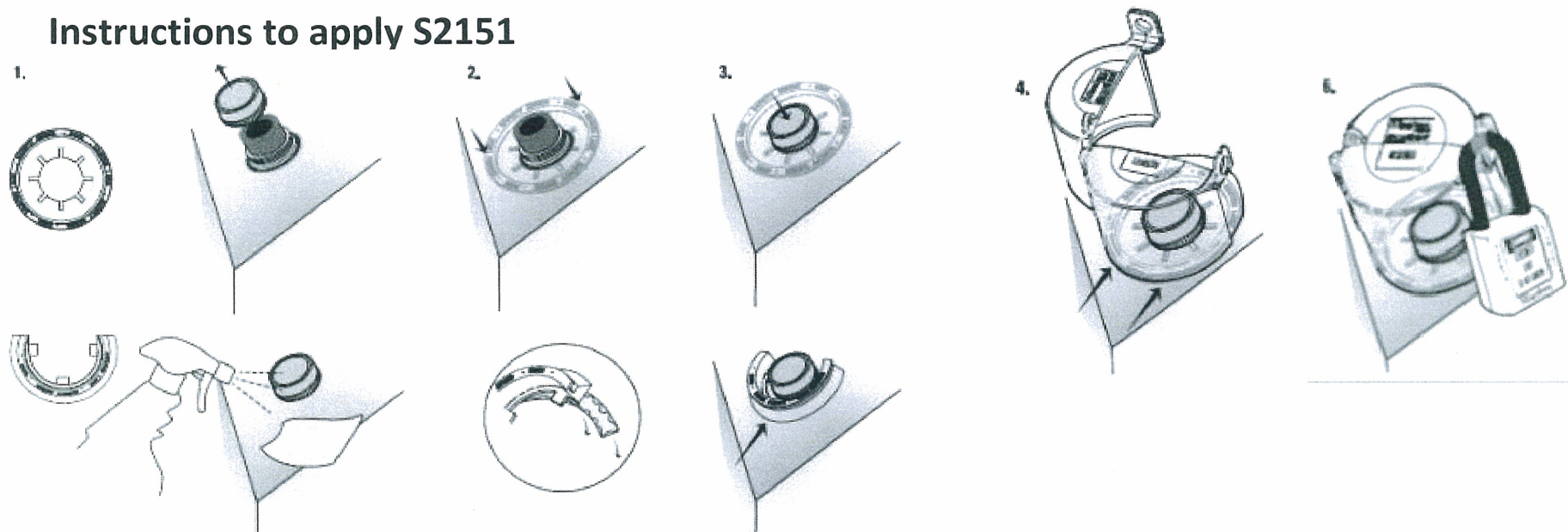

Instructions to apply S2153

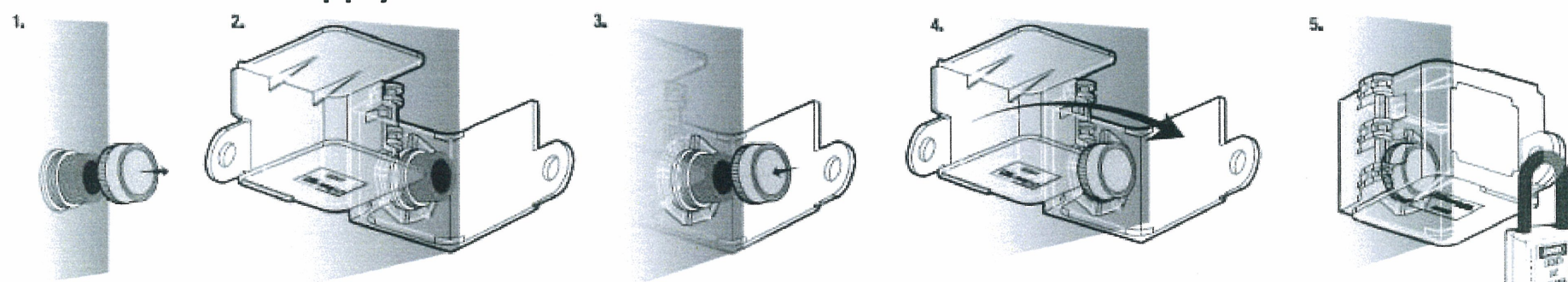

Master
SAFETY SERIES Lock.

